

# HOT WATER BOILING COMPONENTS

## Tank Nipple MI

### Product Specifications

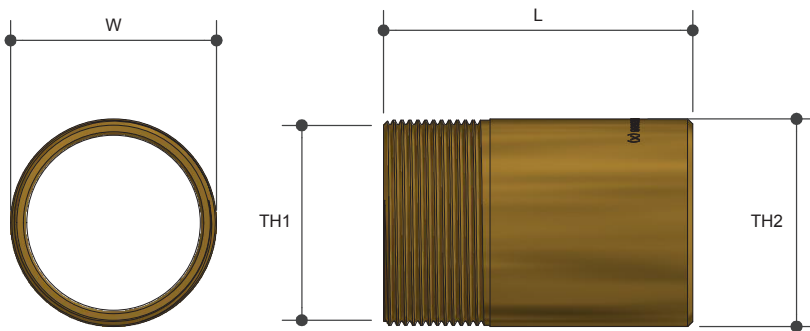

### Specifications

Maximum working temperature 1 °C to 60 °C

Maximum pressure rating 1600kPa

### Sizing Chart (MM)

	L	W	TH1	TH2
BR011	90	60	G 2"	60OD

### Features



Watermark approved

DR Brass

Tested and certified to AS 3688

### Material Chart

Part	Material
Tank Nipple	DR Brass

For more information on Metforge, contact:

Austworld 15 Activity Crescent, Molendinar, Queensland 4214 Australia

P. 1300 780 430

F. 1300 780 441

E. [info@austworld.com.au](mailto:info@austworld.com.au)

Austworld Pty Ltd. All rights reserved 2018. Austworld and Metforge are registered trade mark belonging to Austworld Pty Ltd.

