

SCREWED BRASSWARE

TEE FI Lead Free

Product Specifications

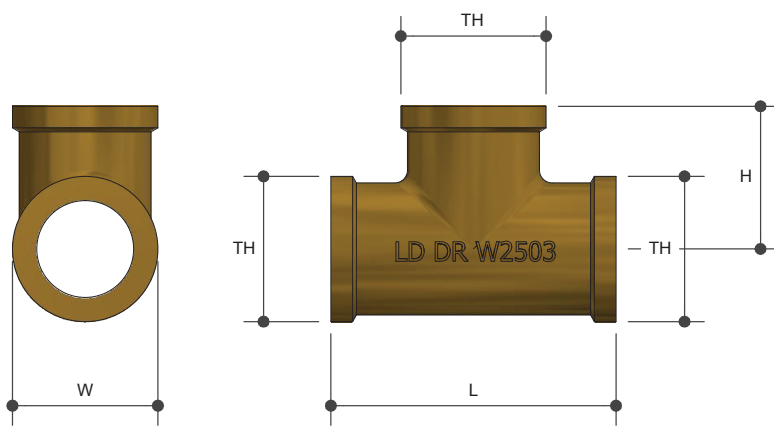

Specifications

Working Temperature 1°C to 95°C

Max. Pressure Rating 1600kPa

Sizing Chart (MM)

	L	H	W	TH
AW401LF	26	13	15	Rp 1/8"
AW402LF	38	19	18	Rp 1/4"
AW403LF	45	22	23	Rp 3/8"
AW404LF	50	25	26	Rp 1/2"
AW404NBLF	50	25	26	Rp 1/2"
AW405LF*	50	25	28	Rp 1/2"
AW406LF	60	30	34	Rp 3/4"
AW406NBLF	60	30	34	Rp 3/4"
AW408LF	68	34	40	Rp 1"
AW408NBLF	68	34	40	Rp 1"
AW410LF	87	44	49	Rp 1 1/4"
AW410NBLF	87	44	49	Rp 1 1/4"
AW411LF	89	45	56	Rp 1 1/2"
AW412LF	112	56	70	Rp 2"
AW413LF	140	70	87	Rp 2 1/2"

* Chrome Plated

For more information on Metforge, contact:

Austworld 15 Activity Crescent, Molendinar, Queensland 4214 Australia

P. 1300 780 430

F. 1300 780 441

E. info@austworld.com.au

Austworld Pty Ltd. All rights reserved 2018. Austworld and Metforge are registered trade mark belonging to Austworld Pty Ltd.

Features

Watermark Lead Free Approved

Tested and Certified to AS 3688

Material Chart

Part	Material
Tee	DR Lead Free Brass

