

# SCREWED BRASSWARE

Hexagon Cap Lead Free

Product Specifications

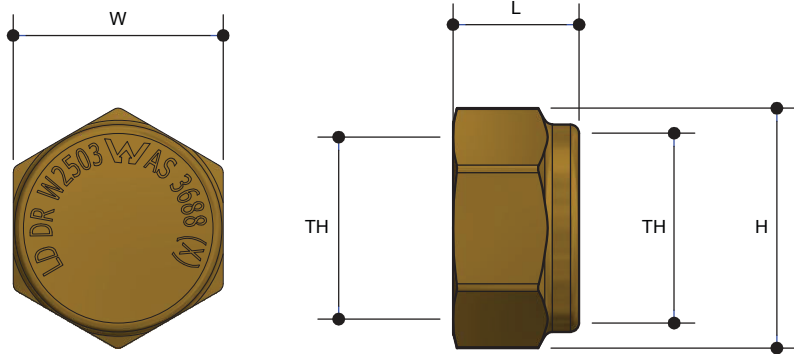

## Specifications

Working Temperature 1°C - 95°C

Maximum Pressure Rating 1600kPa

## Sizing Chart (MM)

	L	H	W	TH
AW535LF	14	27	24	G 1/2"
AW536LF*	14	27	24	G 1/2"
AW537LF	20	36	32	G 3/4"
AW537NBLF	20	36	32	G 3/4"
AW537-1LF	22	40	38	G 1"
AW538-2NBLF	25	50	47	G 1 1/4"
AW538-2LF	25	50	47	G 1 1/4"
AW538-3LF	27	58	54	G 1 1/2"
AW538-4LF	30	71	66	G 2"
AW542LF	14	20	18	G 1/4"

\* Chrome Plated

## Features

Watermark Lead Free Approved

Brass and Chrome Finish

Tested and Certified to AS 3688



## Material Chart

Part	Material
Body	DR Lead Free Brass

For more information on Metforge, contact:  
Austworld 15 Activity Crescent, Molendinar, Queensland 4214 Australia  
P. 1300 780 430 F. 1300 780 441 E. info@austworld.com.au

Austworld Pty Ltd. All rights reserved 2018. Austworld and Metforge are registered trade mark belonging to Austworld Pty Ltd.

