

SCREWED BRASSWARE

Hose Barb MI Lead Free

Product Specifications

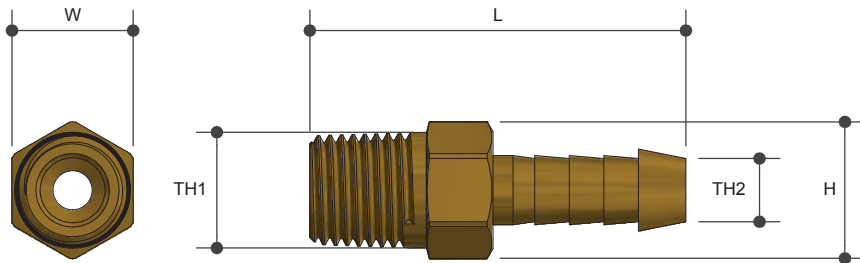

Specifications

Maximum Working Temperature 1°C to 95°C

Maximum Pressure Rating 1600kPa

Sizing Chart (MM)

	L	H	W	TH1	TH2
B0606LF	40	16	14	R 1/4"	6MM
B0608LF	44	16	14	R 1/4"	8MM
B0610LF	42	16	14	R 1/4"	10MM
B0615LF	45	16	14	R 1/4"	15MM
B1006LF	44	20	17	R 3/8"	6MM
B1010LF	43	20	17	R 3/8"	10MM
B1015LF	48	20	17	R 3/8"	15MM
B1510LF	48	25	22	R 1/2"	10MM
B1515LF	51	25	22	R 1/2"	15MM
B1520LF	58	25	22	R 1/2"	20MM
B2015LF	49	32	28	R 3/4"	15MM
B2020LF	60	31	27	R 3/4"	20MM
B2025LF	67	33	29	R 3/4"	25MM
B2520LF	64	39	34	R 3/4"	20MM
B2525LF	69	38	34	R 1"	25MM
B2532LF	71	39	34	R 1"	32MM
B3232LF	71	50	44	R 1 1/4"	32MM
B4040LF	73	53	49	R 1 1/2"	40MM
B5050LF	95	65	61	R 2"	50MM
B6565LF	97	81	76	R 2 1/2"	65MM
B8080LF	122	96	89	R 3"	80MM
B100100LF	133	124	117	R 4"	100MM

For more information on Metforge, contact:

Austworld 15 Activity Crescent, Molendinar, Queensland 4214 Australia

P. 1300 780 430

F. 1300 780 441

E. info@austworld.com.au

Austworld Pty Ltd. All rights reserved 2018. Austworld and Metforge are registered trade mark belonging to Austworld Pty Ltd.



Features

Watermark Lead Free Approved

Tested and Certified to AS 3688

Material Chart

Part	Material
Body	DR Lead Free Brass

