

# SCREWED BRASSWARE

Adaptor MI X FI Extended Lead Free

Product Specifications

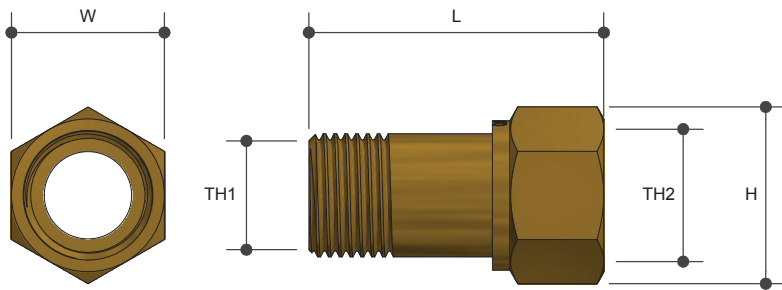

## Specifications

Working Temperature 1°C - 95°C

Maximum Pressure Rating 1600kPa

## Sizing Chart (MM)

	L	H	W	TH1	TH2
AW4009LF	40	28	26	G 1/2"	Rp 1/2"
AW4009NBLF	40	28	26	G 1/2"	Rp 1/2"
AW4008LF*	40	29	26	G 1/2"	Rp 1/2"
AW4000LF	50	30	26	G 1/2"	Rp 1/2"
AW4000NBLF	50	30	26	G 1/2"	Rp 1/2"
AW4003LF*	50	30	26	G 1/2"	Rp 1/2"
AW4001LF	65	29	25	R 1/2"	Rp 1/2"
AW4001NBLF	65	29	25	R 1/2"	Rp 1/2"
AW4002LF*	65	28	26	R 1/2"	Rp 1/2"
AW4004LF	75	30	26	G 1/2"	Rp 1/2"
AW4005LF	75	28	26	R 1/2"	Rp 1/2"
AW4007LF	100	30	26	R 1/2"	Rp 1/2"
AW4006LF*	100	30	26	R 1/2"	Rp 1/2"

\* Chrome Plated

## Features

Watermark Lead Free Approved

Brass and Chrome Finish

Tested and Certified to AS 3688

## Material Chart

Part	Material
Adaptor	DR Lead Free Brass

For more information on Metforge, contact:

Austworld 15 Activity Crescent, Molendinar, Queensland 4214 Australia

P. 1300 780 430

F. 1300 780 441

E. [info@austworld.com.au](mailto:info@austworld.com.au)

Austworld Pty Ltd. All rights reserved 2018. Austworld and Metforge are registered trade mark belonging to Austworld Pty Ltd.

